

# TYPE F

## Ref.: 156.410



ISO/PAS 11154



CITY CRASH TEST



# n° 410



AUDI A4 avant

5

2008->

 } 5 kg + xx Kg = **75 kg max**

Charge maximale admissible indiquée sur la boîte des barres de toit. Ne pas dépasser la charge maximale autorisée par le constructeur du véhicule.  
Il Carico massimo ammissibile è indicato sulla scatola delle barre. Non superare il carico massimo consentito dal costruttore del veicolo.  
Carga máxima admisible indicada en la caja de las barras de techo. No exceda la carga máxima permitida por el fabricante del vehículo.  
Maximum allowable load indicated on the box of roof bars. Do not exceed the maximum load allowed by the vehicle manufacturer.

Maximal zulässige belastung angegeben auf der box der dachreling. Überschreiten sie nicht die maximale belastung durch den fahrzeughersteller zugelassen.

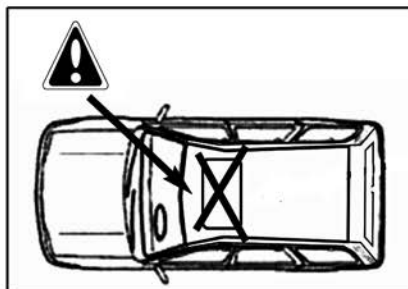
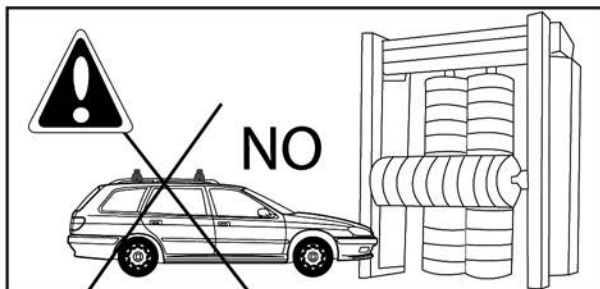
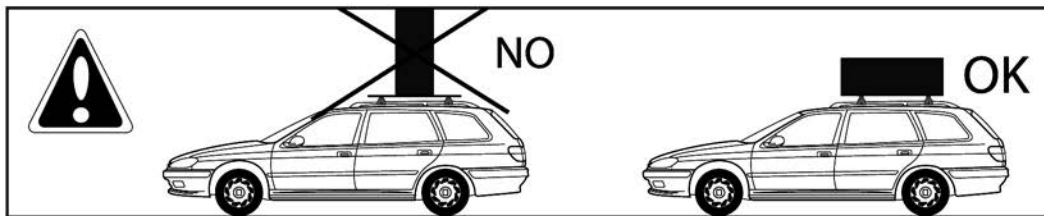
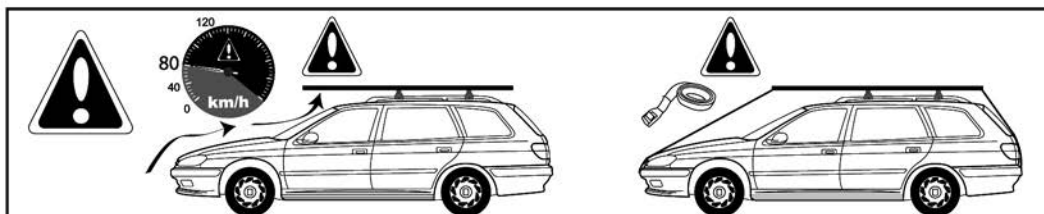



M6x20  
x4

5588.06  
x4

6592.06  
x4

100005  
x1

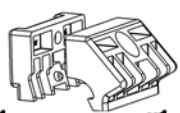

x1  
1641001

x1  
1741001

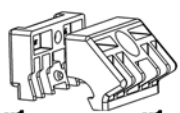

x1  
1641002

x1  
1741002

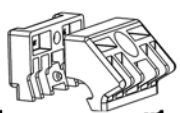

x1  
1641003

x1  
1741003

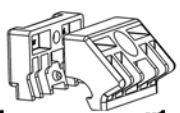

x1  
1641004

x1  
1741004

**1**

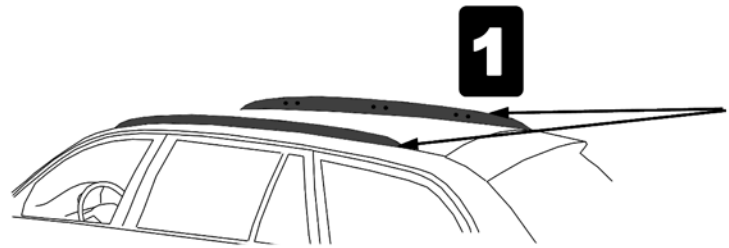

**2**

**x4**

1)

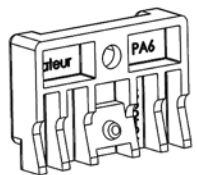

2)

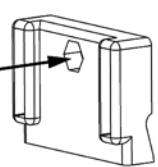

3)

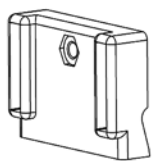

**3**

1641001

1741001

1641002

1741002

x1

x1

x1

x1

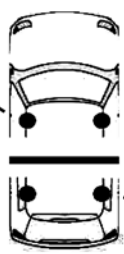

1641003

1741003

1641004

1741004

x1

x1

x1

x1

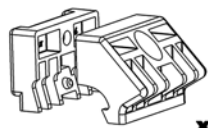
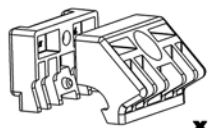

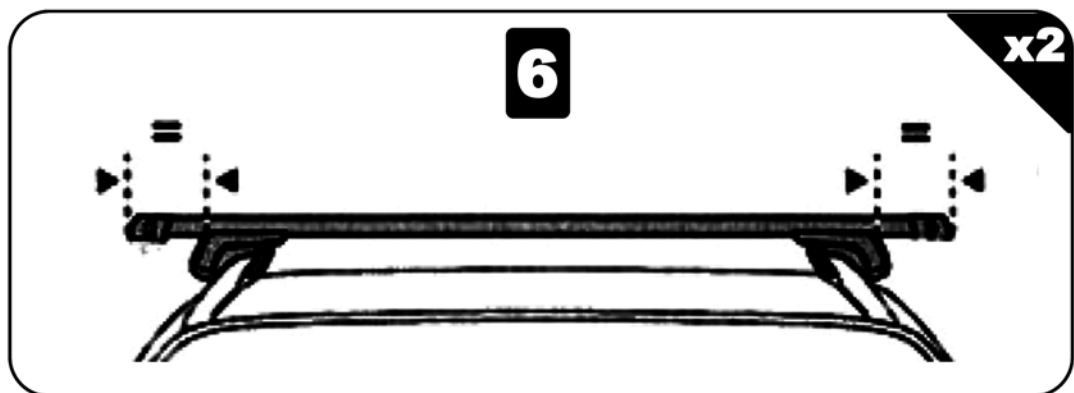
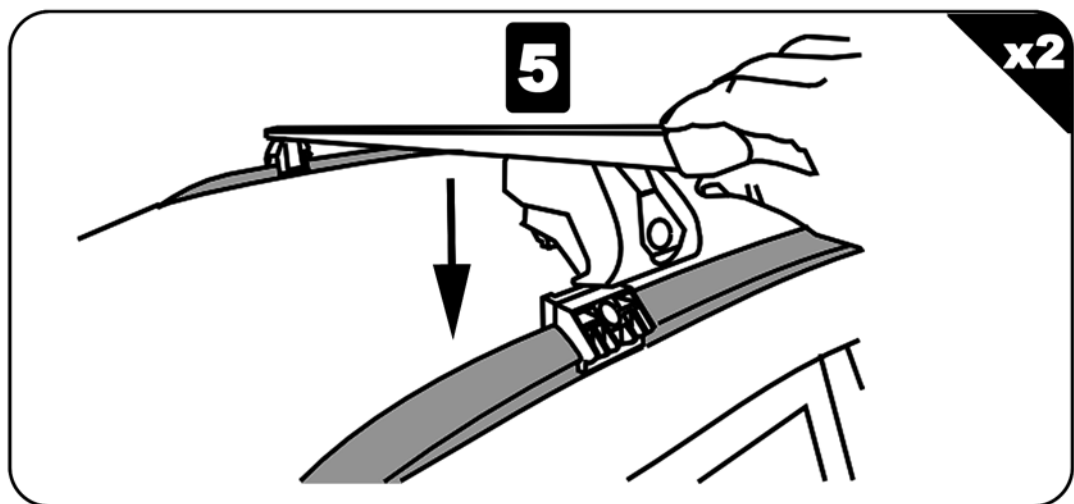
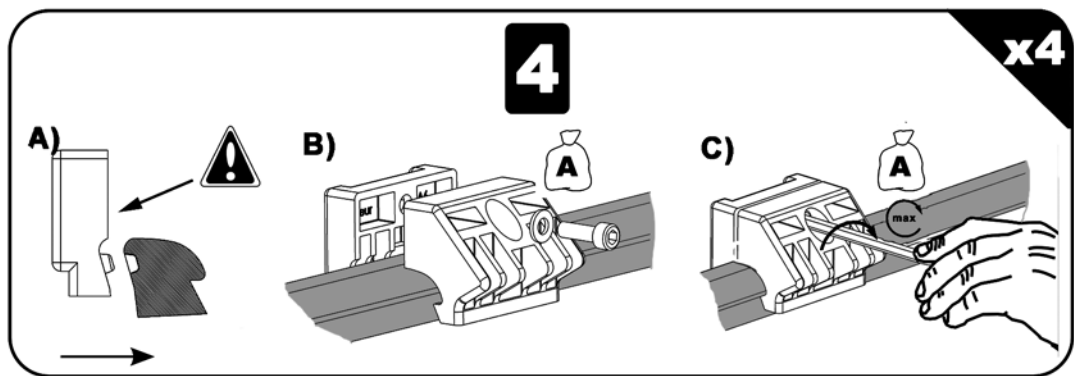

**7**

**x4**

**5 Nm**

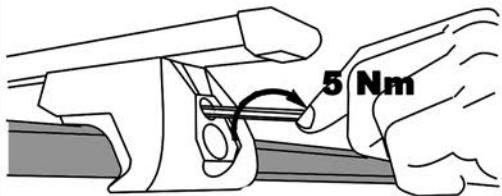

**8**

**x4**

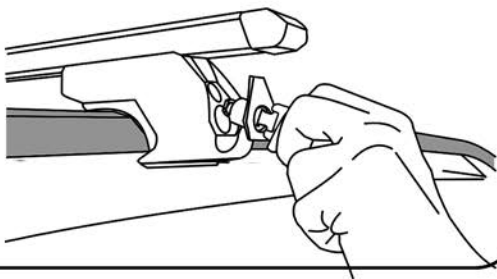

**9**

**CHECK!!**

